

Quick Setup

REPLAYTV 4000 QUICK SETUP GUIDE



Refer to the **Guide to ReplayTV** for connection options not found on this Quick Setup guide and for information on incorporating ReplayTV into your home network.

GETTING STARTED

Take inventory

Make sure you received the following items:

- ReplayTV Digital Video Recorder
- Coaxial cable
- A/V cable
- S-Video cable
- Ethernet cable
- Infrared (IR) blaster cable
- Serial cable
- 9-pin to 15-pin serial cable adapter*
- RJ45 to 9-pin adapter*
- Telephone cable (not needed)
- ReplayTV remote control with two AA batteries
- Guide to ReplayTV
- Registration Card

* Use if the serial cable is not compatible with your satellite receiver.

Note: You may not need to use all of the cables provided. This depends on the types of connectors on your television and if you have a cable box or a satellite receiver.

Before you begin

1. Make sure your home Ethernet network is on.
2. Install the batteries in the ReplayTV remote control according to the diagram inside the battery compartment.

Connection overview

ReplayTV controls and records the television signals you receive (satellite, cable, antenna or a combination of all three). The signals connect directly to the ReplayTV inputs. The outputs from ReplayTV connect to a television or an A/V receiver.

The ETHERNET connector on ReplayTV is used to receive your program listings from the ReplayTV Service™ and to incorporate ReplayTV into your home network for use of the video sharing features.

Easiest connection to your TV

The dashed coaxial cable shows the easiest way to connect ReplayTV to your television. If you have a cable box or satellite receiver you will still need to perform Steps 2-5.

If your components have A/V or S-Video outputs it is recommended that you take advantage of these connectors, which supply better audio and video quality.

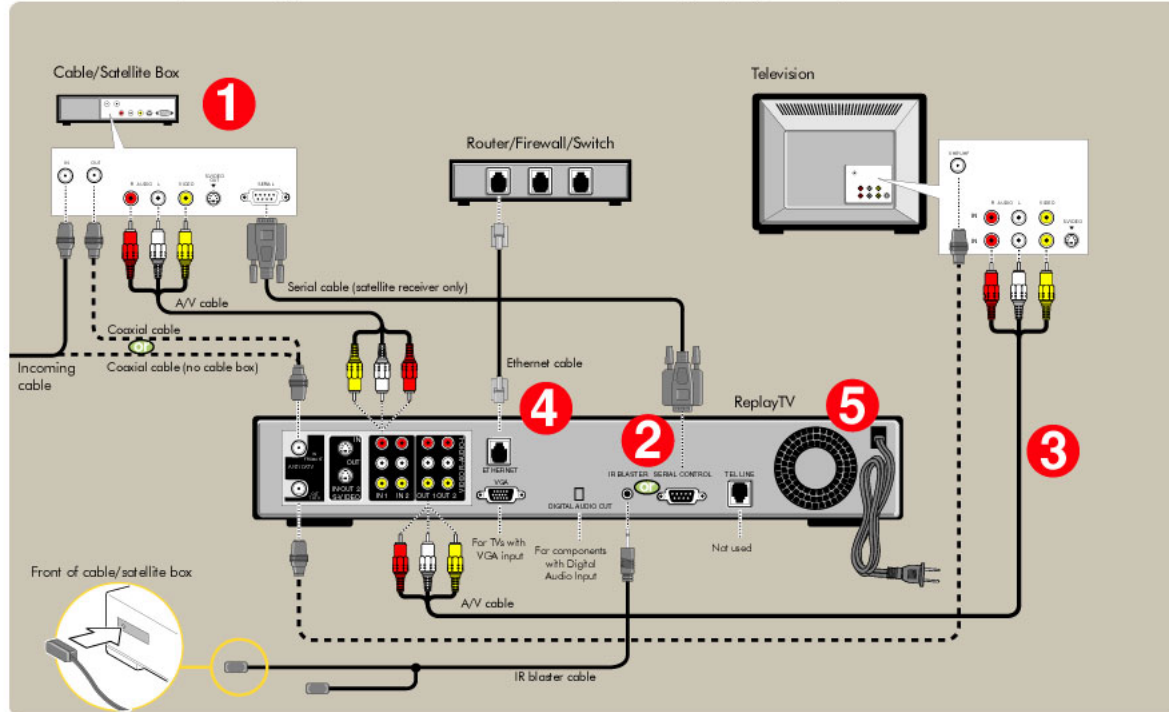

1 Connect incoming signal to ReplayTV

- **If you have a cable box:** Connect a coaxial cable from the OUT connector on your cable box to the IN FROM ANT connector on ReplayTV.

Or

If your cable box has Audio/Video OUT connectors, connect an A/V cable from these connectors to the IN connectors on ReplayTV. *You do not need to connect the coaxial cable if you choose this option.*

- **If you have a satellite receiver:** Connect an A/V cable from the Audio/Video OUT connectors on your satellite receiver to the Audio/Video IN connectors on ReplayTV.

Note: If your cable box or satellite receiver has an S-Video OUT connector, connect an S-Video cable from this OUT connector to the S-Video IN connector on ReplayTV. (The S-Video cable provides better picture quality than the yellow video cable.) Then, connect the audio cables (red and white) from your cable box or satellite receiver to the IN 2 R and L AUDIO connectors on ReplayTV.

2 Attach cable box/satellite receiver controller

If you connect a cable box or satellite receiver to ReplayTV, you need to attach a controller cable so ReplayTV can change the channels on these devices. The controller, either the serial cable or the IR blaster cable, acts as a remote control for these devices.

- If your satellite receiver has a SERIAL connector, connect the serial cable from this connector to the SERIAL CONTROL connector on ReplayTV.
- If your device does not have a SERIAL connector, or if you have a cable box or EchoStar satellite receiver, use the supplied IR blaster.

1. Plug the IR blaster cable into the IR BLASTER connector on ReplayTV.
2. Peel off the protective cover on one of the IR blaster cable emitters.
3. Affix the emitter directly over the IR detector on the cable box or satellite receiver.
4. Hide the unused emitter behind the equipment.

3 Connect ReplayTV to your TV

Connect the supplied A/V cable from the OUT connectors on ReplayTV to the Audio/Video IN connectors on your television, matching like colors.

Note: If your television has an S-Video IN connector, connect an S-Video cable from the S-Video OUT connector on ReplayTV to the S-Video IN connector on your TV. Then, connect the audio cables (red and white) from the OUT 2 R and L AUDIO connectors on ReplayTV to the Audio IN connectors on your TV.

The VGA and DIGITAL AUDIO OUT outputs are for TVs with compatible inputs. **If you use the VGA output, you still need to connect the yellow video cable for the first-time Quick Setup process.**

4 Connect the Ethernet cable to ReplayTV

ReplayTV uses the Ethernet cable to connect to the ReplayTV Service for nightly updates of your Channel Guide—a collection of program listings from your satellite, cable or local television provider. The connection is also used to incorporate ReplayTV into your home network and to use ReplayTV's video sharing features. New features are also sent to your ReplayTV using this connection.

Connect the supplied Ethernet cable to the ETHERNET connector on ReplayTV and to your home network. (Refer to the *Guide to ReplayTV* for information on system setup.)

5 Plug in ReplayTV and complete the on-screen setup

IMPORTANT: All other connections must be done before turning on ReplayTV.

1. Plug the ReplayTV power cord into an electrical outlet.
2. Turn on your television and other components.
3. Press the ReplayTV POWER button on the remote control. **Note:** It will take a few minutes for ReplayTV to start up. You should see the following screen:

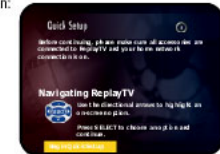

4. Follow the on-screen instructions to complete the setup and begin using ReplayTV.
- If you do not see the Quick Setup screen, try one of these tips:

- Make sure the power light is illuminated on the ReplayTV front panel. (If not, press the ReplayTV POWER button on the remote control.)
- Press the TV/VIDEO or INPUT button on your TV until the screen displays.
- Tune your television to the channel that displays auxiliary INPUT. (Refer to your TV owner's manual.)
- Recheck your connections.
- Refer to "Troubleshooting" in the *Guide to ReplayTV*.

For more help call Customer Care
800-933-5899

©2001 SONY/Blue, Inc. Part No. 4105605